



PLASTERS FOR THERMAL INSULATION SYSTEM

www.revco.hu

Revco Magyarország Kft.
2310 Szigetszentmiklós, Leshegy út 5.
Telefon: 06-24-525-525 E-mail: info@revco.hu

OUR SERVICES

Project Support

Starting from 2018, we put a strong focus on project support, as this is where we can best assist both the construction industry and our reseller partners.

Our colleagues and sales staff keep track of the ongoing projects, from establishing contact to final processing, where we also provide free technical advice by answering any questions that may arise, including in person.



NEO thin plasters

With synthetic resin dispersion binder, dilutable with water,

- with quartz filler (1.5mm), spachtel (scraped effect)
- with quartz filler (2 mm), structure (rolling granular)

Thin plaster sold in buckets which contains UV-resistant pigments and property improving additives, available in the lighter colours of the VARIO colour card.



spachtel
(scraped effect) 1.5 mm



structure
(rolling granular) 2 mm



Outdoor



Indoor

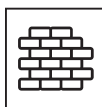

Can be
applied on
mineral
surfaces



Risk of frost



Can be
applied with
a spraygun



Can be
applied with
a plastering
trowel



Can be
diluted with
water



VARIO thin plasters

A product developed on the recommendation of professionals.

Thin plaster offered in buckets, extremely easy to process, fibre reinforced, ready-mixed, dilutable with water, with resin dispersion binder,

- with quartz filler roll putz (rolled)
- with quartz filler (1mm, 1.5mm and 2.5mm) and a spachtel (scraping) effect
- with quartz filler (2mm and 3mm), structure (rolling granular)

containing property improving additives, available in all colours on the VARIO colour card (320 types).



roll putz
(rolled)



spachtel
(scraped effect) 1 mm



spachtel
(scraped effect) 1,5 mm



spachtel
(scraped effect) 2.5 mm



structure
(rolling granular) 2 mm



structure
(rolling granular) 3 mm



Outdoor



Indoor

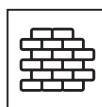

Can be
applied on
mineral
surfaces



Risk of frost



Can be
applied with
a paint roller



Can be
applied with
a spraygun



Can be
applied with
a plastering
trowel

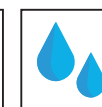

Can be
diluted with
water



SILICON thin plasters

Thin plaster offered in buckets, ready-mixed, dilutable with water, with silicone resin binder,

- quartz filler (1.5mm), spachtel (scraper effect)
- quartz filler (2 mm), structure (rolling granular)

containing UV-resistant pigments and property improving additives, available in certain colours on the VARIO colour card.

With outstanding moisture permeability that is easy to clean. Colour durability is ensured by a **27 year colour guarantee!**



spachtel
(scraped effect) 1.5 mm



structure
(rolling granular) 2 mm



Outdoor



Indoor

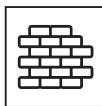

Can be applied on mineral surfaces



Risk of frost



Can be applied with a spraygun



Can be applied with a plastering trowel



Can be diluted with water



SILICATE plasters

Thin plaster offered in buckets, ready-mixed with potassium water glass binder,

- with quartz filler (1.5mm), spachtel (scraper effect)
- with quartz filler (2 mm), structure (rolling granular)

containing UV-resistant pigments and property improving additives, available in certain colour on the VARIO colour card.



spachtel
(scraped effect) 1.5 mm



structure
(rolling granular) 2 mm



Outdoor



Indoor

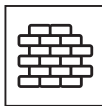

Can be applied on mineral surfaces



Risk of frost



Can be applied with a spraygun



Can be applied with a plastering trowel



Can be diluted with water



PAINTS

Outdoor wall paints

SILICON EXTERIOR facade paint

Outdoor breathable facade paint which contains ready-mixed silicone resin binder, pigments, filler and property improving additives, with good coverage, high abrasion resistance, high vapour permeability, easy-to-clean, high quality matt paint available in certain colours of the VARIO colour card.

Recommended for new and old mineral base plaster, for lime sand brick and clinker brick surfaces, for suitable load-bearing dispersion paints and resin plaster. Suitable also for mineral and plastic based thermal insulation systems. Durable coating for surfaces of historic buildings.

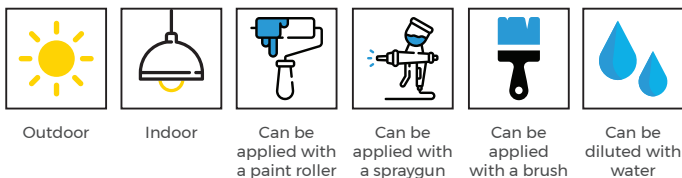

EXTERIOR facade paints

Ready-mixed matt wall paint with dispersion binders, pigments, fillers and property improving additives with excellent coverage and excellent abrasion resistance, available in all colours on the VARIO colour card (320).

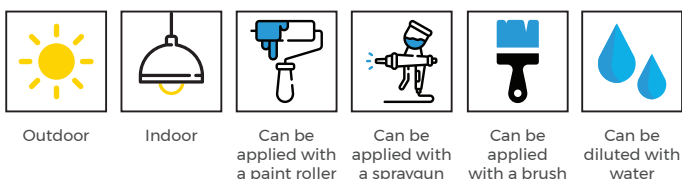

SILICATE EXTERIOR facade paint

Ready-mixed matt wall paint containing water glass binder, pigments, filler and property improving additives, with excellent coverage and vapour-permeable property, available in certain colours on the VARIO colour card.

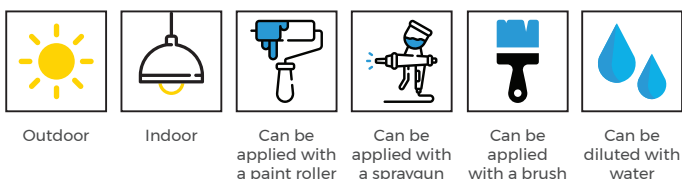

HEAT INSULATORS, HEAT INSULATION SYSTEMS, ADHESIVES

Today these concepts are already associated with our company name. We are the guarantor of our complete thermal insulation systems!

REVCO THERMO-LINE thermal insulation system

REVCO EPS 80/GRAPHITE EPS 80*
facade insulation board

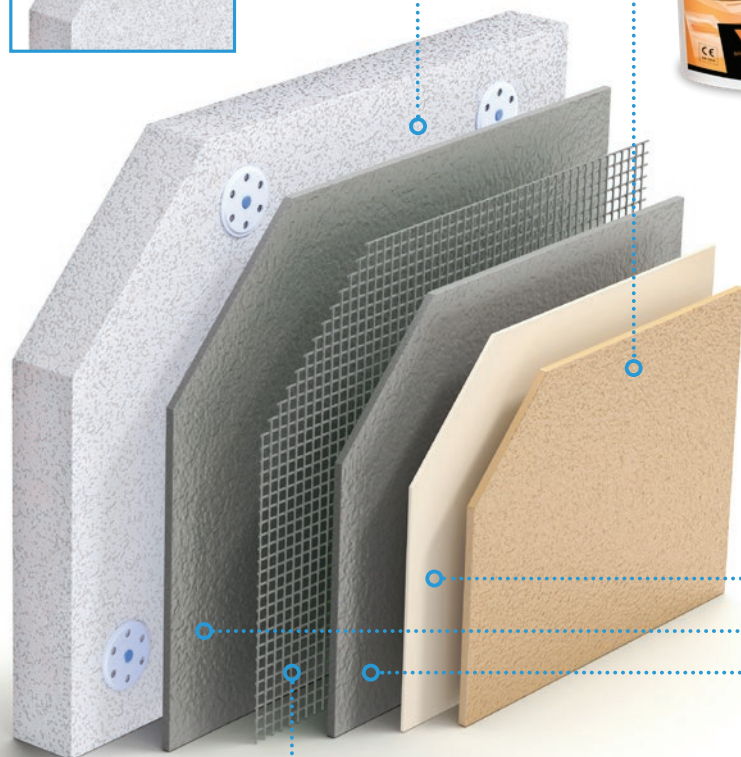

REVCO THIN PLASTER



REVCO PRIMER/SILICATE
plaster primer



REVCO FIX VARIO/PREMIUM
adhesive patch for gluing and filling polystyrene sheets



REVCO FIBREGLASS MESH



* Use of FIX PREMIUM is recommended.

TECHNICAL INFORMATION

Components of the REVCO THERMO-LINE thermal insulation system (NMÉ: A-104/2014)

Adhesive and trowel mortar	Thermal insulation material	Mesh	Mechanical Fixings	Plaster primers	Cover plasters
REVCO FIX VARIO adhesive and laying mortar	<p>EPS 80 (normal and graphite) EPS EN 13163-T1-L2-W2-S2-P5-DS(70,-)3-BS125-CS(10)80-DS(N)2-TR150 standard marked, max. up to 300 mm thickness</p> <p>Rockwool MW EN 13162-T5-CS(10/Y)10-TR7, 5-WS-WL(P)-MU1,4 standard marked, min. 90 kg/m³ body density, max. up to 300 mm thickness</p>	Fibreglass mesh (alkali resistant, 145 g/m ²)	Recessed metal screw plastic anchors (can be replaced with plastic anchors with a plastic nail, plastic anchors with a metal tensioner and plastic dowel, plastic anchors with a metal punching nail), plinths and other profiles	REVCO PRIMER and REVCO SILICATE plaster primers	REVCO NEO, REVCO VARIO, REVCO SILICATE and REVCO SILICON thin plasters

Further information: <http://revco.hu/thermo-line-homlokzati-hoszigetelo-rendszer-letoltheto-dokumentumok>

Components of the REVCO MINERAL thermal insulation system (NMÉ: A-104/2014)

Adhesive and trowel mortar	Thermal insulation material	Mesh	Mechanical fixings	Plaster primers	Cover plasters
REVCO FIX PREMIUM Adhesive and laying mortar	<p>Rockwool MW EN 13162-T5-CS(10/Y)10-TR7, 5-WS-WL(P)-MU1,4 standard marked, min. 90 kg/m³ body density, without thickness limitation</p>	Fibreglass mesh (alkali resistant, 145 g/m ²)	Recessed metal screw plastic anchors (can be replaced with plastic anchors with a plastic nail, plastic anchors with a metal tensioner and plastic dowel, plastic anchors with a metal punching nail), plinths and other profiles	REVCO PRIMER and REVCO SILICATE plaster primers	REVCO VARIO, REVCO SILICATE and REVCO SILICON thin plasters

Further information: <http://revco.hu/mineral-homlokzati-hoszigetelo-rendszer-letoltheto-dokumentumok>

Fire Safety

THERMO-LINE thermal insulation system			MINERAL insulation system		
Basic feature	Performance	Evaluation method	Basic feature	Performance	Evaluation method
Fire protection class:	<p>For REVCO NEO, REVCO VARIO, REVCO SILICATE plaster: B-s1, d0*</p> <p>For REVCO SILICON plaster: B-s2, d0*</p>	MSZ EN 13501-1:2007+A1:2010	Fire protection class:	For REVCO VARIO, REVCO SILICATE, REVCO SILICON plaster: A2-s2, d0**	MSZ EN 13501-1:2007+A1:2010
Facade fire spread limit (min):	$T_h \geq 45^{****}$	MSZ 14800-6:2009	Facade fire spread limit (min):	$T_h \geq 45^{***}$	MSZ 14800-6:2009

PLASTER SELECTOR

		NEO	VARIO	SILICON	SILICATE
Binder		resin	resin	silicone resin	Potassium water bottle
Spachtel (scraped effect)	1 mm	✗	✓	✗	✗
Spachtel (scraped effect)	1,5 mm	✓	✓	✓	✓
Spachtel (scraped effect)	2,5 mm	✗	✓	✗	✗
Structure (rolling granular)	2 mm	✓	✓	✓	✓
Structure (rolling granular)	3 mm	✗	✓	✗	✗
Roll putz (rolled)		✗	✓	✗	✗
Colours	Full colour palette	✗	✓	✗	✗
	Specified colours	✓	✗	✓	✓
Processability	Appropriate				✓
	Very good	✓			
	Outstanding		✓	✓	
Vapour permeability	Appropriate	✓			
	Very good		✓		
	Outstanding			✓	✓
Usable	THERMO-LINE thermal insulation system (EPS)	✓	✓	✓	✓
	MINERAL thermal insulation system (Rockwool)		✓	✓	✓
Consumption	1 mm		1,5-1,7 kg/m ²		
	1,5 mm		2,4-2,6 kg/m ²		
	2 mm		2,4-2,6 kg/m ²		
	2,5 mm		3,0-3,2 kg/m ²		
	3 mm		2,7-2,9 kg/m ²		
	Roll putz		1-2 kg/m ²		
Dilution		with max. 2dl of water			
Temperature		The temperature of the air and of the wall surface should be between + 5 °C and + 25 °C!			The temperature of the air and of the wall surface should be between +8°C and +25°C!
Total drying time		10 hours (at 20 °C and 42% humidity)			
Surface painting		In 24 hours (After repainting the appearance of the plaster may change!)			
Cleaning		Clean with a fine brush and clean water! All types of detergents and cleaning agent should be avoided!			
Storage		In the original unopened packaging - in a frost-free place for 2 years. Buckets should be carefully closed after use!			In the original unopened packaging - in a frost-free place for 1 year. Buckets should be carefully closed after use!
Containers		15 kg	15 kg / 3,75 kg	15 kg	15 kg
Other		10 years warranty Reliable quality at an affordable price!	10 years warranty High quality resin plaster with the full colour card choice!	27 years colour guarantee Optimal coating for wall structures with good vapour permeability!	10 years warranty Ideal for historic buildings!